

U.K. Counties Athletic Union

Affiliated to UK Athletics Limited

President: PETER MATTHEWS



**BRITISH
ATHLETICS**



Dear Colleague

February 2014

Thank you, for your Entries to our CC Championships. I enclose details of how to get to Cofton Park and parking arrangements (map included), also details of limited changing.

NOTE: New arrangements for Car Parking, but coaches with athletes and Tents can be dropped off in Lowhill Lane which will be sign posted opposite the registration tent then go to the allocated car park.

Please note that **ELECTRONIC CHIP TIMING** will be used again this year for all races. Please can you or your athletes pick up their numbers with their electronic chip from the Registration Tent marked No.15 on site map. Then all athletes **MUST** go through the **START MARQUEE** to be checked that the chip is fitted on their ankle before they enter into the start area.

NOTE: This year Chips & Nos. for the first 5 races will be available from 9.00 am. However Chips & Nos. for the last 5 races will be available from 11.00 am.

NOTE: If you have an Athlete with any Medical Problems could you please ask them to write their condition on the back of their race number and also a contact phone number. Also, a form will be available for team managers to leave a mobile contact number in the registration tent.

Please note that the event will again be televised live on BSKYB.

Programme:

11:05am	U20 Men	8000M
11:33am	U13 Boys	3000M
11:51am	Senior Women	8000M
12:23pm	U15 Boys	4500M
12:42pm	U17 Women	5000M
13.08pm	U20 Women	6000M
13:33pm	U13 Girls	3000M
13:53pm	U17 Men	6000M
14:15pm	U15 Girls	4000M
14:36pm	Senior Men	12000M

I look forward to meeting you all at the Championships on 8th March 2014

Yours in Sport

Joe Mower
Cross County Secretary

**British Athletics Inter Counties UK Cross Country Championships and
UK Cross Challenge Final
Cofton Park – Saturday 8th March 2014**

Directions to Event

Cofton Park – Pass holders (Restricted Access) only

Lowhill Lane entrance - B45 8UN

From M42 junction 1 and M5 junction 4 take the A38/A491 exit to Birmingham (SW). At the roundabout take the third exit onto Birmingham Road/A38 continue to follow the A38 (Bristol Road South) at the roundabout take the second exit onto Lickey road, B4120. Turn left onto Lowhill Lane for Cofton Park.

Club tent drop off

Lowhill Lane

The drop off area will be located near to the MG Rover site. Look out for the signage.

VIP/Officials & Coach Parking– MG Rover Sales Centre

Lowhill Lane - B31 2BQ

From M42 junction 1 and M5 junction 4 take the A38/A491 exit to Birmingham (SW). At the roundabout take the third exit onto Birmingham Road/A38 continue to follow the A38 (Bristol Road South) at the roundabout take the second exit onto Lickey road, B4120. Turn left onto Lowhill Lane for MG Rover.

Staff/Marshalls Car Park – Cofton Park Nursery

Lickey Road - B45 8UR

From M42 junction 1 and M5 junction 4 take the A38/A491 exit to Birmingham (SW). At the roundabout take the third exit onto Birmingham Road/A38 continue to follow the A38 (Bristol Road South) at the roundabout take the second exit onto Lickey road, B4120. Continue straight ahead until you reach the entrance to the nursery on your left.

Overflow Event car park (pay & display)

Situated on Bristol Road South (A38), opposite Bournville College. £1.50 parking fee applies.

From M42 junction 1 and M5 junction 4 take the A38/A491 exit to Birmingham (SW). At the roundabout take the third exit onto Birmingham Road/A38 continue to follow the A38 (Bristol Road South) at the roundabout take the first continuing along Bristol Road South. The car park is situated at the traffic lights entrance on the left.

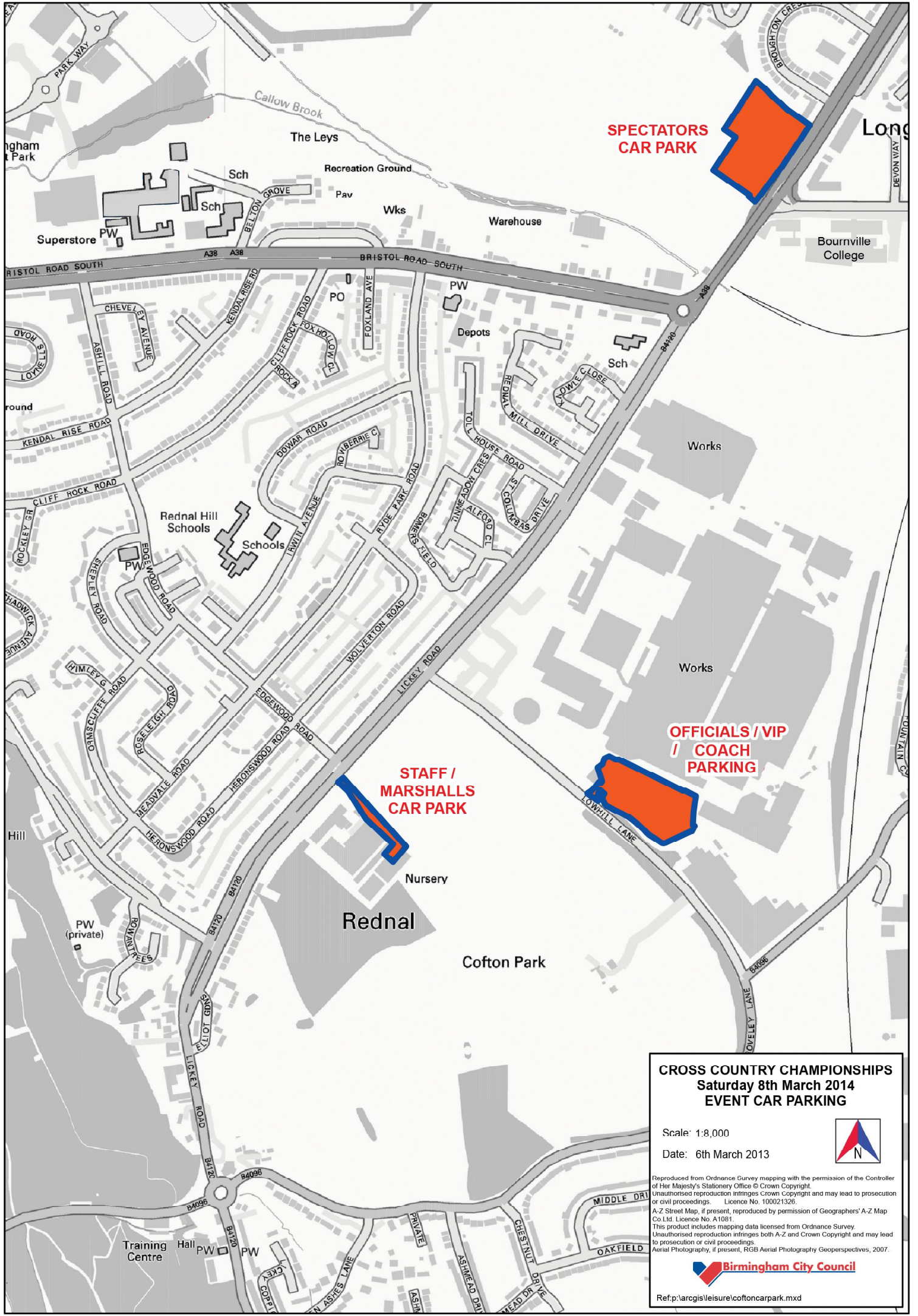

**SPECTATORS
CAR PARK**

**STAFF /
MARSHALLS
CAR PARK**

**OFFICIALS / VIP
/ COACH
PARKING**

**CROSS COUNTRY CHAMPIONSHIPS
Saturday 8th March 2014
EVENT CAR PARKING**

Scale: 1:8,000
Date: 6th March 2013



Reproduced from Ordnance Survey mapping with the permission of the Controller of Her Majesty's Stationery Office © Crown Copyright.
Unauthorised reproduction infringes Crown Copyright and may lead to prosecution or civil proceedings. Licence No. 100021326.
A-Z Street Map, if present, reproduced by permission of Geographers' A-Z Map Co Ltd. Licence No. A1081.
This product includes mapping data licensed from Ordnance Survey.
Unauthorised reproduction infringes both A-Z and Crown Copyright and may lead to prosecution or civil proceedings.
Aerial Photography, if present, RGB Aerial Photography Geoperspectives, 2007.



Ref.p:\arogis\leisure\coftoncarpark.mxd

BRITISH ATHLETICS INTER COUNTIES UK CROSS COUNTRY CHAMPIONSHIPS AND UK CROSS CHALLENGE FINAL

Saturday 8th March 2014

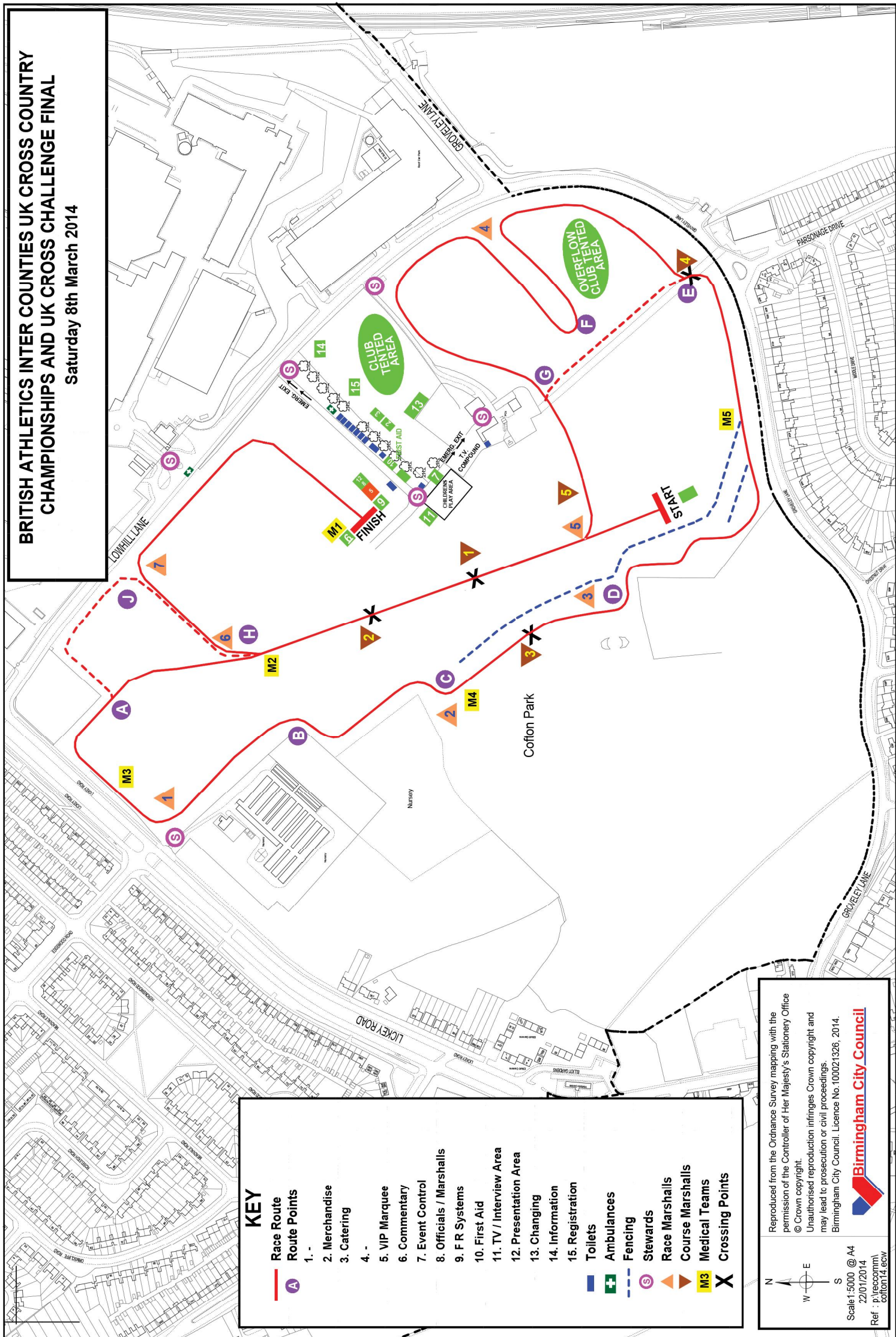

KEY

Race Route	Route Points
1. - Merchandise	Toilets
2. Catering	Ambulances
3. - VIP Marquee	Fencing
4. - Commentary	Stewards
5. Event Control	Race Marshalls
6. Officials / Marshalls	Course Marshalls
7. FR Systems	Medical Teams
8. First Aid	Crossing Points
9. TV / Interview Area	
10. Presentation Area	
11. Changing	
12. Information	
13. Registration	

Reproduced from the Ordnance Survey mapping with the permission of the Controller of Her Majesty's Stationary Office.
 © Crown copyright.
 Unauthorised reproduction infringes Crown copyright and may lead to prosecution or civil proceedings.
 Birmingham City Council. Licence No. 100021326, 2014.

Scale: 1:5000 @ A4
 22/01/2014
 Ref: p:\veccomm\cotton14.ecw